

NOTE: A PARALLEL STREET IS RECOMMENDED EACH SIDE OF TYPE I CHANNELS THE AREA BETWEEN THE STREETS SHOULD BE DEDICATED TO PUBLIC USE

TYPE I-NATURAL

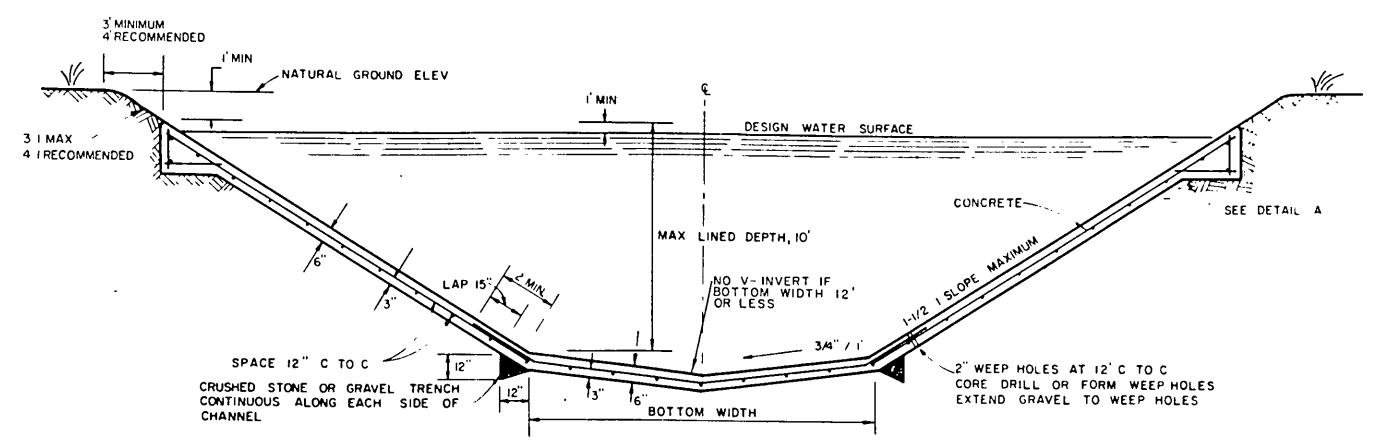

TYPE III NORMAL CHANNEL SECTION

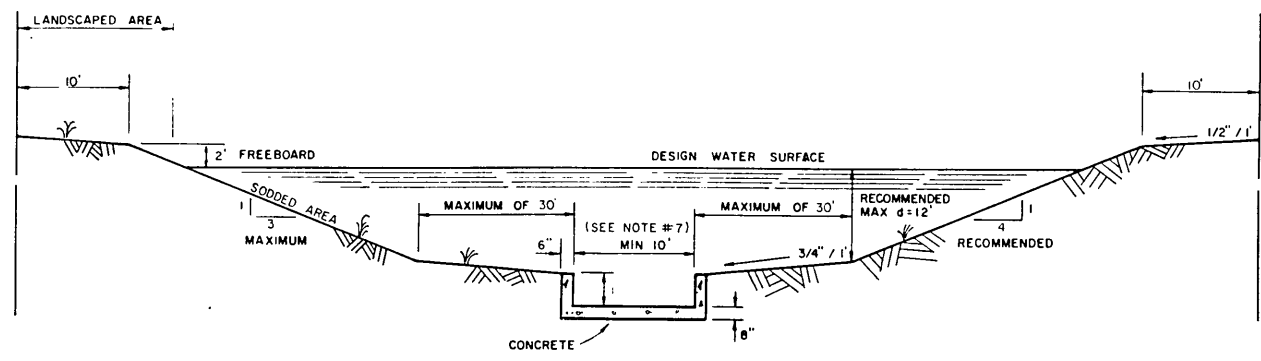

TYPE II - UNLINED WITH LINED PILOT CHANNEL

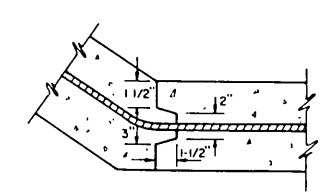

CONSTRUCTION JOINT OPTIONAL

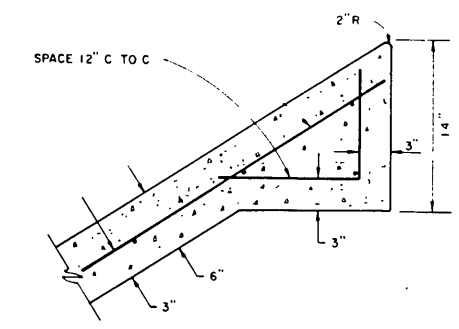

SLAB EDGE-DETAIL "A"

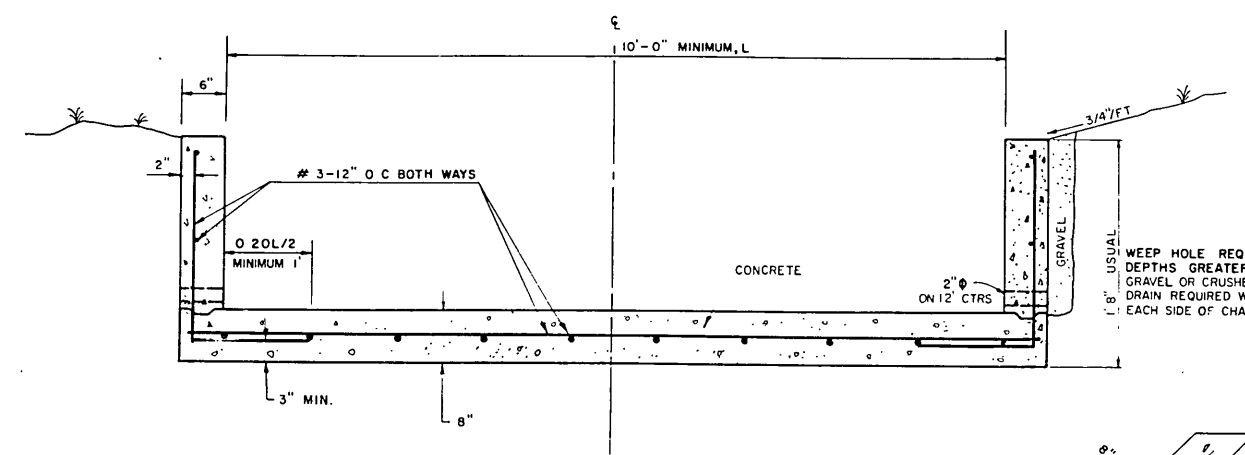

PILOT CHANNEL DETAIL

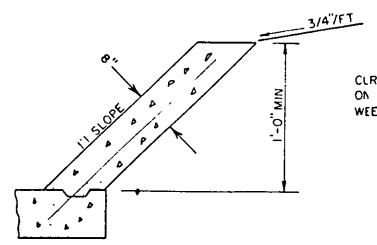

CURBS MAY BE CONSTRUCTED ON A 1:1 SLOPE WITHOUT WEEP HOLES

GENERAL NOTES FOR OPEN CHANNELS

1. CONSTRUCTION JOINT SHOWN FOR CONVENIENCE ONLY-MONOLITHIC CONSTRUCTION MAY BE USED
2. ALL VISIBLE SURFACES SHALL BE A TROWEL FINISH
3. ALL REINFORCING STEEL SHALL BE 3/8" DIAMETER AND SPACED 16" C TO C BOTH WAYS UNLESS OTHERWISE SPECIFIED
4. TYPE I CHANNEL, A NATURAL CHANNEL, IS SHOWN FOR LOCATION OF ADJACENT STREETS
5. IF WOOD FORMS ARE USED WITH CONSTRUCTION JOINT THEY SHALL BE TWO, 2"x4", AND SHALL NOT BE REMOVED UNTIL CONCRETE ON SLOPES IS READY TO BE PLACED.
6. ALL CONCRETE IN LINED CHANNEL SHALL BE 3000 PSI
7. FLAT BOTTOM TO BE CONSTRUCTED WHEN CHANNEL WIDTH IS LESS THAN 12'
8. PROVIDE CONCRETE OVERFLOW FLUME AT ALL SAG POINTS TO ACCOMMODATE 100 YR. FLOOD FREQUENCY.

SLEEVE FOR DOWEL SHALL HAVE AN INSIDE DIAMETER OF 7/8" AND SHALL BE 5" LONG

3/4" DIAMETER BARS SPACED 21" C TO C SHALL SERVE AS DOWELS DOWELS SHALL BE ASPHALT COATED 12" ON THE FREE END

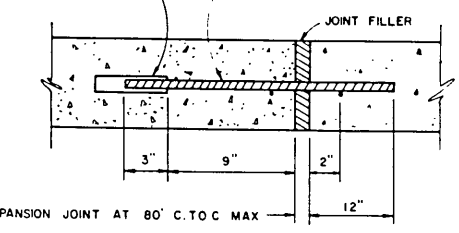

TRANSVERSE EXPANSION JOINT

CITY OF SACHSE, TEXAS DEPARTMENT OF ENGINEERING	
STANDARD CONSTRUCTION DETAILS STORM DRAINAGE	
CHANNEL SECTIONS	
APPROVED	JAN. 20, 1986
DATE JAN., 1985	REVISED 4-90 SHEET 15